

PLAYGROUNDS CAN OFFER MANY OPPORTUNITIES FOR CHILDREN TO FURTHER DEVELOP PHYSICAL, COGNITIVE, SENSORY AND SOCIAL SKILLS. AN INCLUSIVE DESIGN INCLUDES A BALANCE OF PLAY EXPERIENCES TO BUILD ALL THESE SKILLS.
-LANDSCAPE STRUCTURES

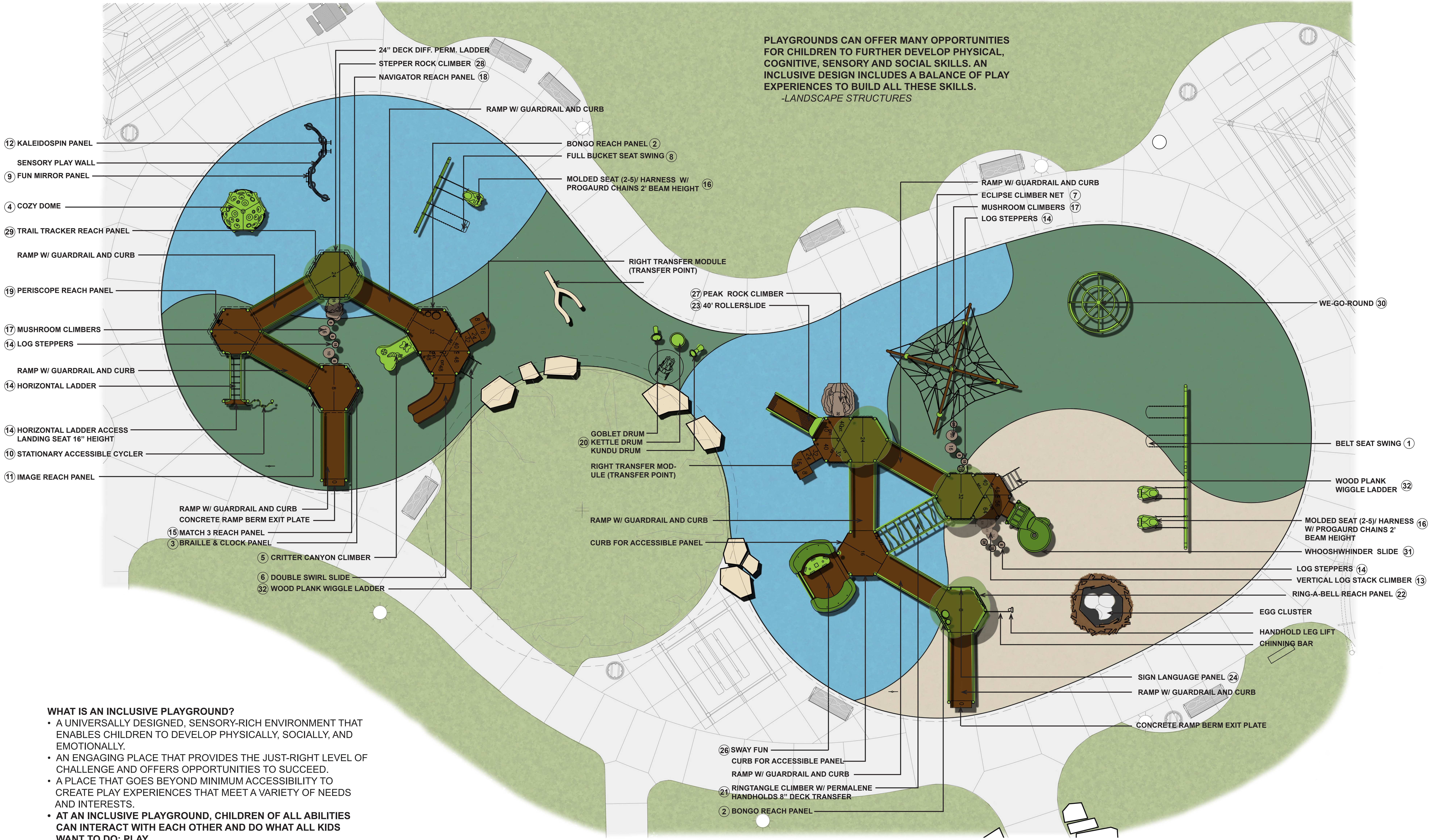

WHAT IS AN INCLUSIVE PLAYGROUND?

- A UNIVERSALLY DESIGNED, SENSORY-RICH ENVIRONMENT THAT ENABLES CHILDREN TO DEVELOP PHYSICALLY, SOCIALLY, AND EMOTIONALLY.
- AN ENGAGING PLACE THAT PROVIDES THE JUST-RIGHT LEVEL OF CHALLENGE AND OFFERS OPPORTUNITIES TO SUCCEED.
- A PLACE THAT GOES BEYOND MINIMUM ACCESSIBILITY TO CREATE PLAY EXPERIENCES THAT MEET A VARIETY OF NEEDS AND INTERESTS.
- **AT AN INCLUSIVE PLAYGROUND, CHILDREN OF ALL ABILITIES CAN INTERACT WITH EACH OTHER AND DO WHAT ALL KIDS WANT TO DO: PLAY.**

-LANDSCAPE STRUCTURES